



Model TTFH

## Model TTFH

Variable area flow meter model TTFH is designed for measuring and monitoring large water flows. Featuring a stainless steel unitized body and flange construction this meter is very durable, especially suited to industrial applications.

### FEATURES

- Sturdy construction
- Flanged connections

### TYPICAL APPLICATIONS

- Water treatment plants
- Power plants

### OPTIONS

- Low flow alarm
- Viton® or EPDM seals



**Model TTFH**

Max. temperature	167°F
Max. pressure	230 psi
Body	AISI 316
Flowtube	Acrylic
Float	AISI 329
Seals	Nitrile (Viton®, EPDM)*
Accuracy	±5% F.S. (H <sub>2</sub> O @ 70°F)
Connections	4" ANSI 150# RF AISI 316 Flanged or DN80 Flanged
Weight	39 lbs

\*)special construction on request

TTFH- [ ] - [ ]

4A	<b>H<sub>2</sub>O flow range</b> 20 - 160 USG/min	
4B		20 - 260 USG/min
A	<b>Scale</b> H <sub>2</sub> O scale l/min (70°F)	
G		H <sub>2</sub> O scale USG/min (70°F)
D	<b>Options</b> Alarm readiness	
N		Connections 4" ANSI 150# RF Flange
V		Viton® seals

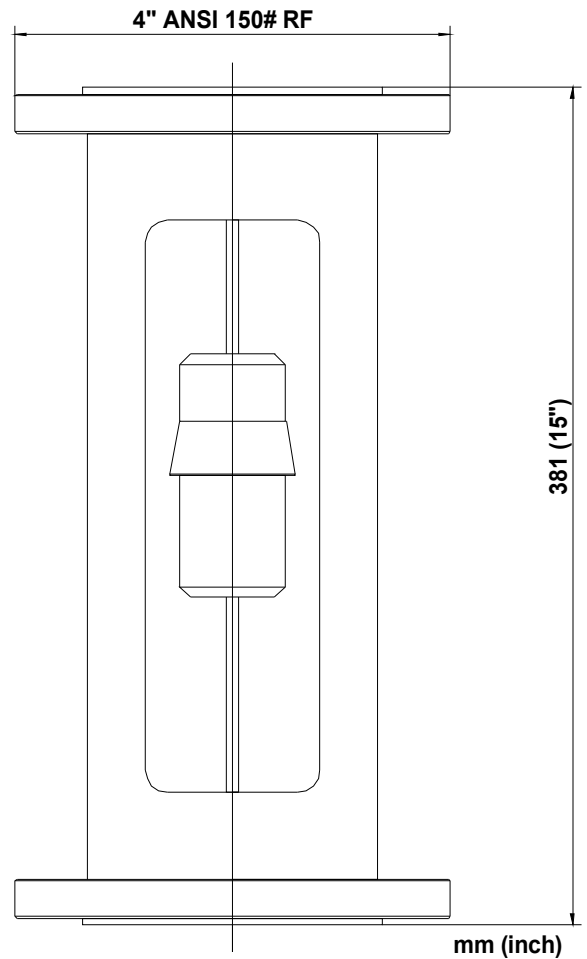

TTFH\_US 2005-01-06



1000 de La Gauchetiere West, Suite 2400  
 Montreal, Quebec, H3B 4W5 • CANADA  
 Phone (514) 448-2171 • Fax (514) 448-5151  
 email: info@kytola.ca • www.kytola.ca

Representative: