



# LarFlex Type 71

## Type 71

Flanged designed to bolt directly to existing flanges or new installations, flanges are drilled I50# standard. Other drilling standards such as: ANSI 250/300#, British Standard 10, JIS, and DIN as well as square flanges are also available upon request. Can be installed in either vertical or horizontal applications.

### Benefits of the LarFlex Type 71 Rubber Check Valves

- All rubber construction resists abrasive slurries
- NSF61 is standard construction
- Very quiet operation with no water hammer
- Its unique design prevents backflow
- Negligible maintenance and energy costs
- Will not warp or freeze
- Quick interchange with any flap type check valve
- Available in sizes 1" – 96"

For Specific Elastomer Recommendations, See:		LAROX "Chemical To Elastomer Guide"				
LAROX Style Number	Cover Elastomer	Tube Elastomer	Max. Operating Temp. °F (°C)		Branding Label Color	F.S.A. Material Class
71/BB	Chlorobutyl	Chlorobutyl	250°	(121°)	Black	STD. III
71/EE	EPDM	EPDM	250°	(121°)	Red	STD. III
71/NH	Neoprene	Hypalon®	212°	(100°)	Green	STD. II
71/NN	Neoprene	Neoprene	225°	(107°)	Blue	STD. II
71/PP	Nitrile	Nitrile	212°	(100°)	Yellow	STD. II
71/NV	Neoprene	Viton®	225°	(107°)	Orange	STD. III

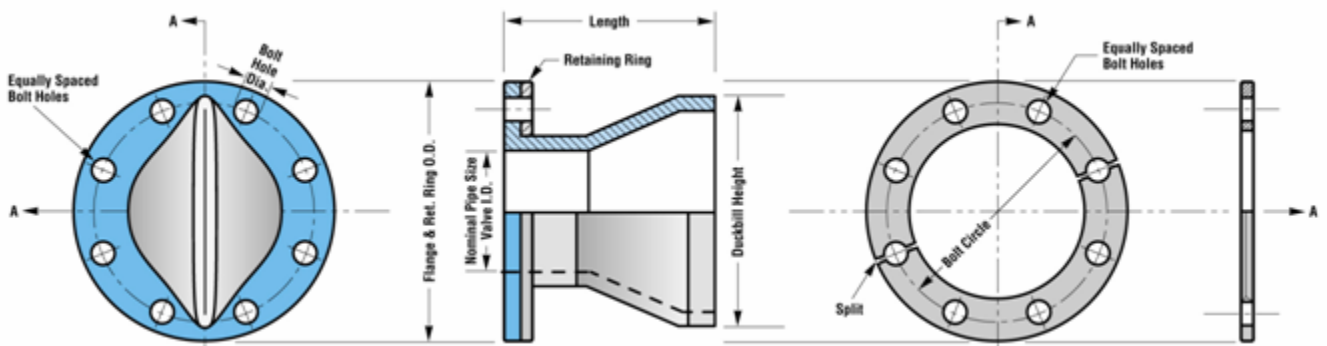

LAROX FLOWSYS INCORPORATED • 808 BARKWOOD COURT, SUITE N • LINTHICUM, MD 21090

TEL. 410-636-2250 • FAX 410-636-9062

E-MAIL [INFO@LAROX.FI](mailto:INFO@LAROX.FI) • [WWW.LAROX.US](http://WWW.LAROX.US)

Information without engagement. All rights to changes without prior notice reserved.



# LarFlex Type 71

Nominal Pipe Size  Inch / (mm)	Standard Dimensions for Style 71		Standard Drilling for Style 71				Weights	
	Length	Duckbill Height	Flange O.D.	Bolt Circle	No. of Holes	Size of Holes	lbs / (kgs)	
	Inch / (mm)	Inch / (mm)	Inch / (mm)	Inch / (mm)		Inch / (mm)		
1 (25)	4 (102)	2.125 (54)	4.25 (107.95)	3.13 (79.50)	4	0.625 (15.9)	3 (1.4)	
1.5 (40)	5 (127)	2.625 (67)	5.00 (127.00)	3.88 (98.55)	4	0.625 (15.9)	4 (1.8)	
2 (50)	6.5 (165)	3.875 (99)	6.00 (152.40)	4.75 (120.65)	4	0.750 (19.1)	6 (2.7)	
2.5 (65)	7.5 (191)	4.625 (118)	7.00 (177.80)	5.50 (139.70)	4	0.750 (19.1)	8 (3.6)	
3 (80)	8.5 (216)	5.50 (140)	7.50 (190.50)	6.00 (152.40)	4	0.750 (19.1)	10 (4.5)	
4 (100)	10 (254)	7.375 (188)	9.00 (228.60)	7.50 (190.50)	8	0.750 (19.1)	14 (6.4)	
5 (125)	12 (305)	8.75 (223)	10.0 (254.00)	8.50 (215.90)	8	0.875 (22.2)	17 (7.7)	
6 (150)	13 (330)	10.50 (267)	11.0 (279.40)	9.50 (241.30)	8	0.875 (22.2)	22 (10.0)	
8 (200)	15 (381)	13.75 (350)	13.5 (342.90)	11.75 (298.45)	8	0.875 (22.2)	27 (12.2)	
10 (250)	17 (432)	17.00 (432)	16.00 (406.40)	14.25 (361.95)	12	1.000 (25.4)	39 (17.7)	
12 (300)	19 (483)	19.625 (499)	19.0 (482.60)	17.00 (431.80)	12	1.000 (25.4)	62 (28.1)	
14 (350)	21 (533)	24.75 (629)	21.00 (533.40)	18.75 (476.25)	12	1.125 (28.6)	81 (36.7)	
16 (400)	24 (610)	26.500 (674)	23.50 (596.90)	21.25 (539.75)	16	1.125 (28.6)	125 (56.7)	
18 (450)	26 (661)	29.75 (756)	25.00 (635.00)	22.75 (577.85)	16	1.250 (31.8)	210 (95.3)	
20 (500)	32 (813)	31.50 (801)	27.50 (698.50)	25.00 (635.00)	20	1.250 (31.8)	312 (141.5)	
24 (600)	42 (1067)	43.00 (1093)	32.00 (812.80)	29.50 (749.30)	20	1.375 (34.9)	410 (186.0)	
28 (700)	45 (1143)	46.00 (1169)	36.50 (927.10)	34.00 (863.60)	28	1.375 (34.9)	483 (219.1)	
30 (750)	47 (1194)	49.00 (1245)	38.75 (984.25)	36.00 (914.40)	28	1.375 (34.9)	555 (251.7)	
32 (800)	53 (1346)	51.00 (1296)	41.75 (1060.45)	38.50 (977.90)	28	1.625 (41.3)	605 (274.4)	
36 (900)	58 (1473)	55.25 (1404)	46.00 (1168.40)	42.75 (1085.85)	32	1.625 (41.3)	665 (301.6)	
42 (1050)	62 (1575)	66.25 (1683)	53.00 (1346.20)	49.50 (1257.30)	36	1.625 (41.3)	965 (437.7)	
48 (1200)	72 (1829)	74.50 (1893)	59.50 (1511.30)	56.00 (1422.40)	44	1.625 (41.3)	1005 (455.9)	
54 (1350)	74 (1880)	78.25 (1988)	66.25 (1682.75)	62.75 (1593.85)	44	2.000 (50.8)	1085 (492.1)	
60 (1500)	82 (2083)	85.00 (2159)	73.00 (1854.20)	69.25 (1758.95)	52	2.000 (50.8)	1285 (582.9)	
72 (1800)	98 (2489)	105.00 (2667)	86.50 (2197.10)	82.50 (2095.50)	60	2.000 (50.8)	1500 (680.4)	

- Larger sizes available upon request
- Weights are approximate

LAROX FLOWSYS INCORPORATED • 808 BARKWOOD COURT, SUITE N • LINTHICUM, MD  
21090

TEL. 410-636-2250 • FAX 410-636-9062  
E-MAIL INFO@LAROX.FI • WWW.LAROX.US

Information without engagement. All rights to changes without prior notice reserved.